

12
SLOPE 3
MIN.

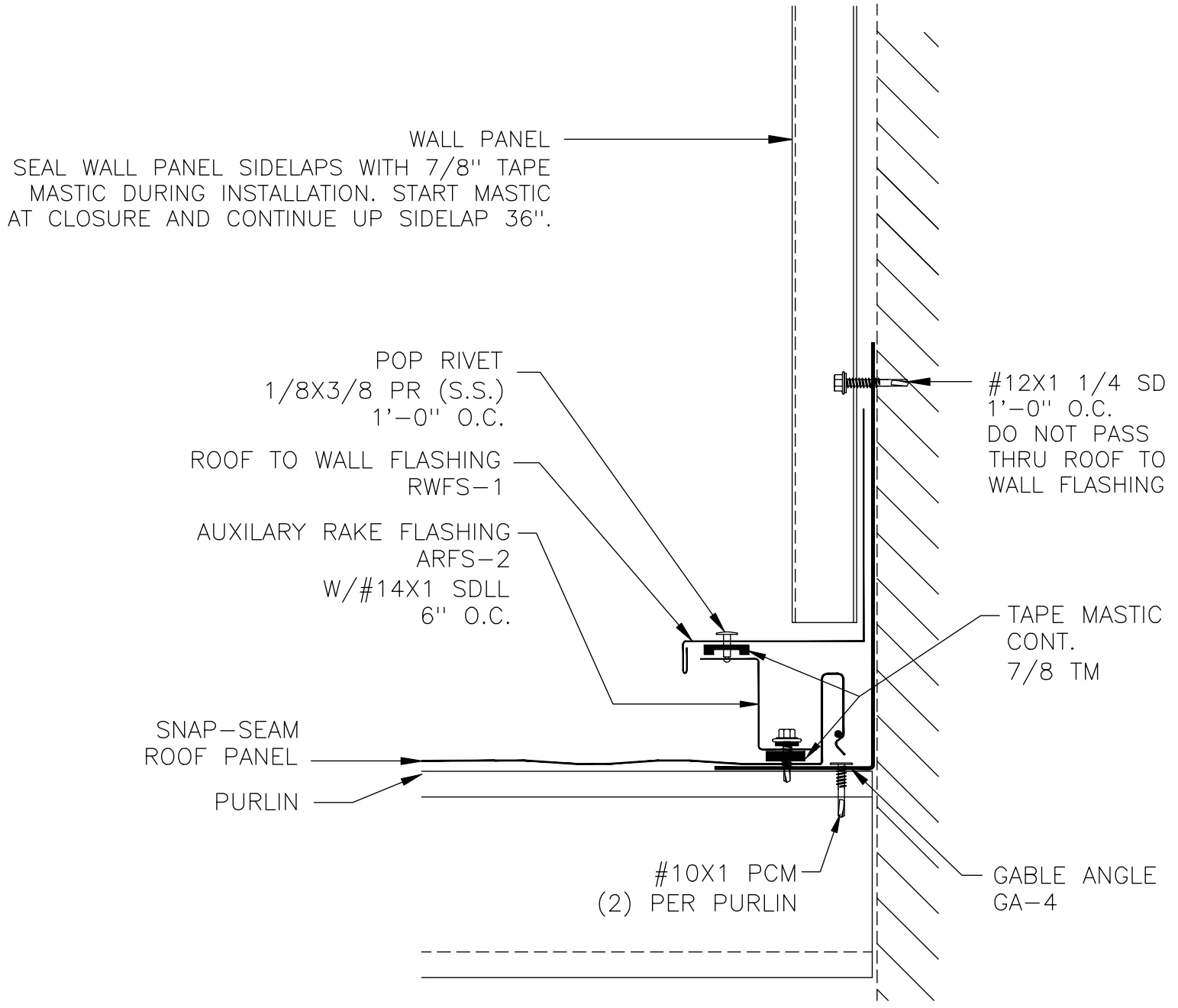

GABLE ROOF TO WALL ON FRAMING (STARTING)
FOR SNAP-SEAM PANEL (PINNED CONDITION)

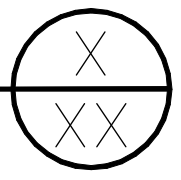

| | |
|--------------|----------|
| SCALE: NONE | DATE: |
| DRAWN BY: KP | 03/06/09 |
| CHECKED BY: | |
| REVISED BY: | |

SNAP-SEAM
GABLE ROOF TO WALL
ON FRAMING

DWG NO: SS.3.C.1